

REVISIONS AND AMENDMENTS		
DATE	DESCRIPTION	BY

I HEREBY CERTIFY THAT THIS PLAN WAS PREPARED BY ME AND THAT I AM A DULY REGISTERED PROFESSIONAL ENGINEER UNDER THE LAWS OF THE STATE OF MINNESOTA.

DATE: \_\_\_\_\_ REG. NO.: \_\_\_\_\_  
 WIDSETH SMITH ADLTING & ASSOCIATES, INC.  
 CROOKSTON, MINNESOTA

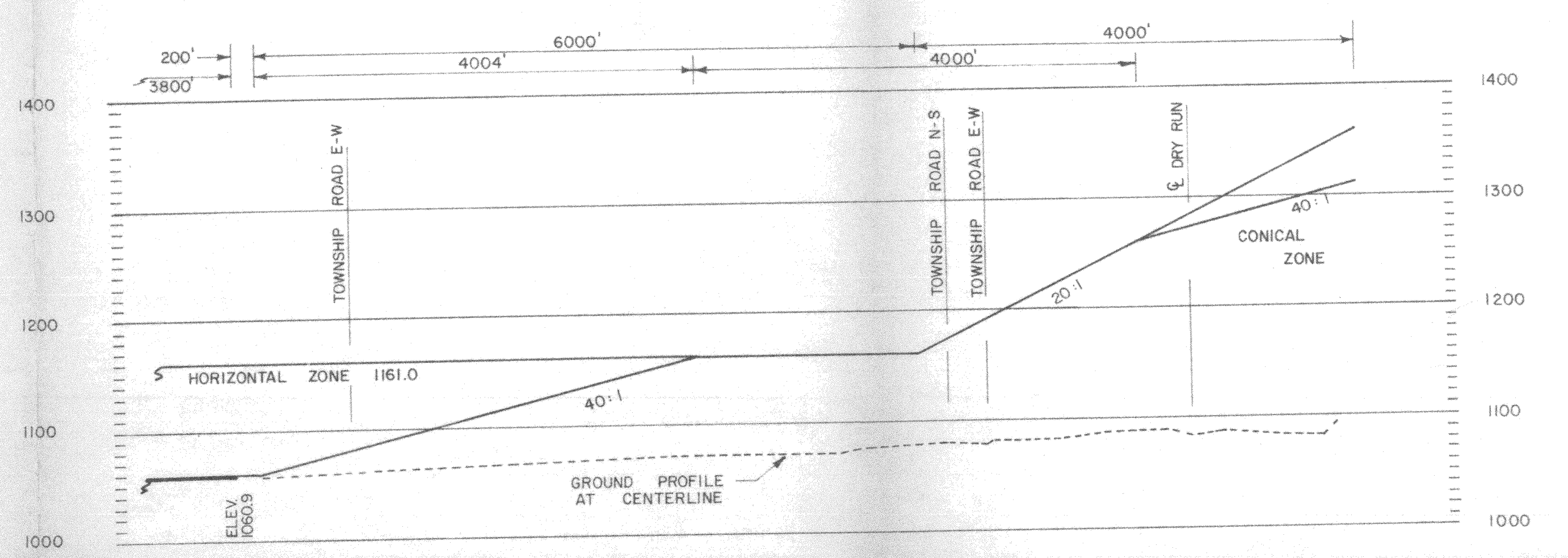
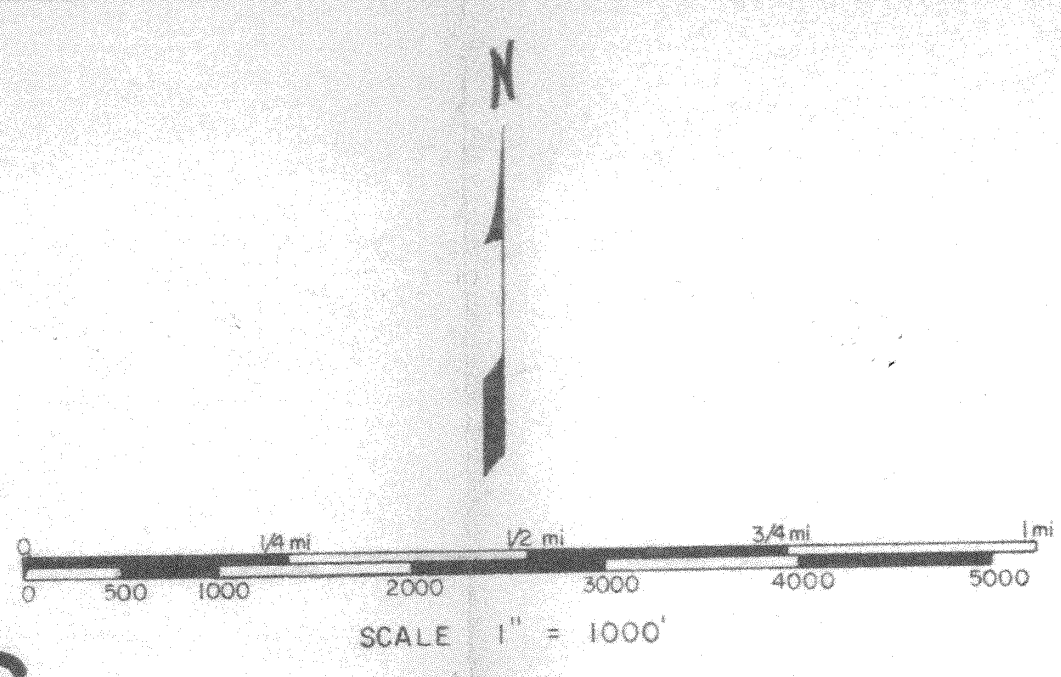
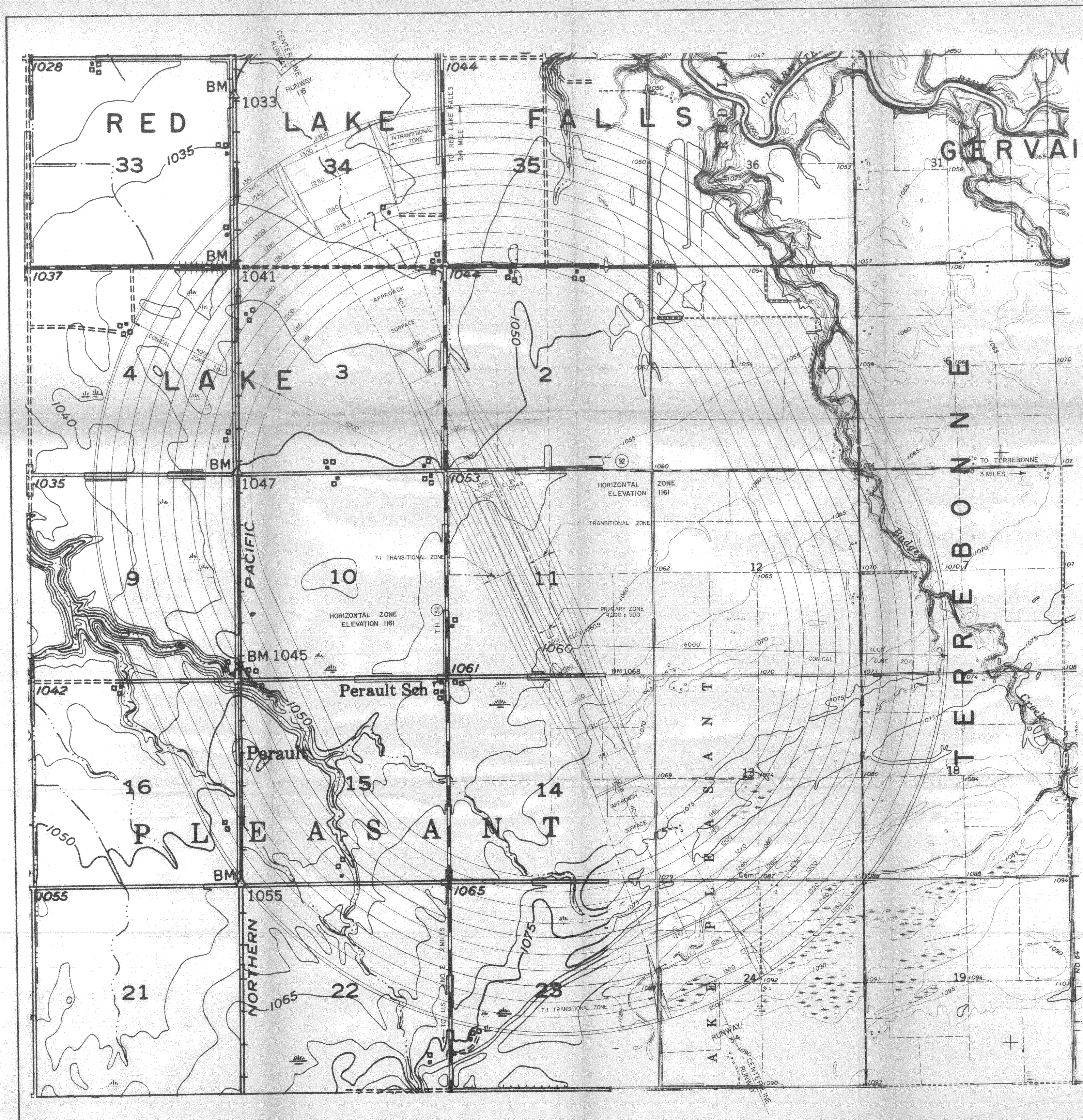

RUNWAY 34 (SE APPROACH)

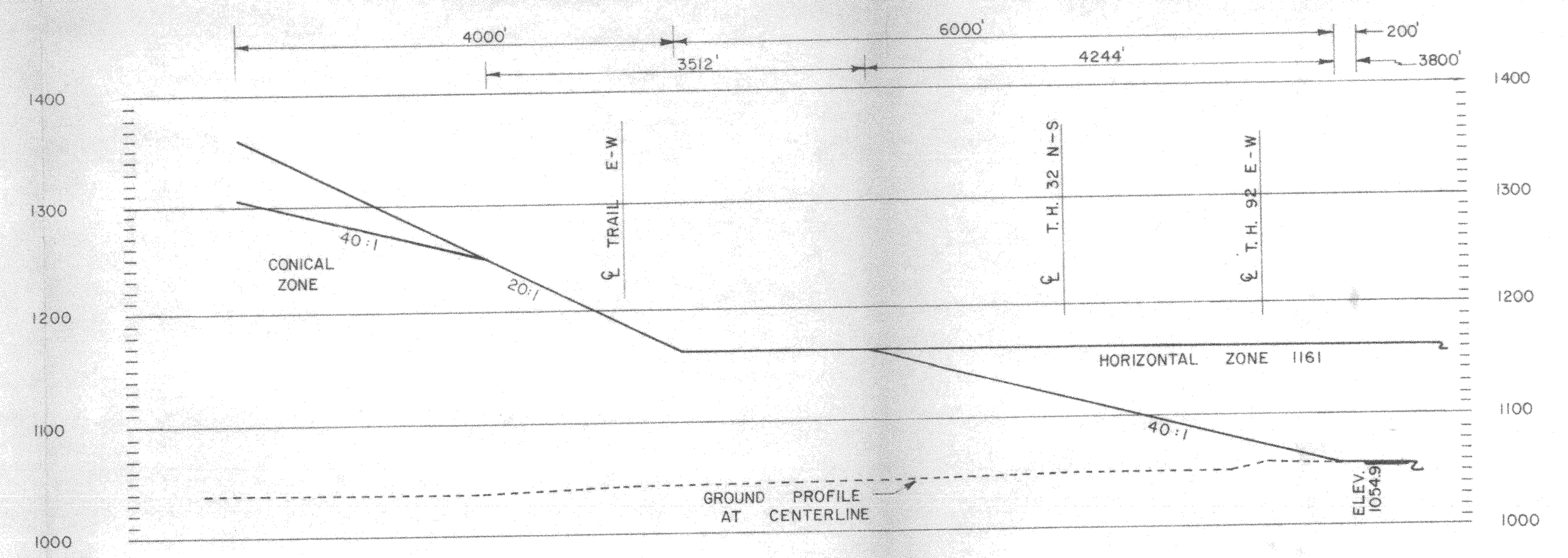

RUNWAY 16 (NW APPROACH)

**NOTES**

- AIRPORT ELEVATION 1061 SEA LEVEL DATUM
- THE AERIAL CONTOURS ILLUSTRATE THE HEIGHT LIMITATIONS WITHIN EACH IMAGINARY SURFACE. THE CONTOURS ARE ON SEA LEVEL ELEVATION DATUM.
- A SLOPE, SUCH AS 40:1 EXPRESSES THE HORIZONTAL DISTANCE OF 40 FEET TO THE VERTICAL DISTANCE OF 1 FOOT.
- EXISTING TOPOGRAPHIC SYMBOLS ARE THOSE USED BY THE U.S. GEOLOGICAL SURVEY.
- THE BASE MAP IS A REPRODUCTION OF: RED LAKE FALLS, MINNESOTA QUADRANGLE 1952 - 15 MINUTE SERIES; TERREBONNE, MINNESOTA QUADRANGLE 1964 - 7.5 MINUTE SERIES

**LEGEND**

- AIRPORT BOUNDARY - EXISTING
- TOPOGRAPHIC CONTOURS
- AERIAL CONTOURS

\* FROM U.S. GEOLOGICAL SURVEY MAP 15 MINUTE SERIES & 7.5 MINUTE SERIES

JANUARY 30, 1976

**RED LAKE FALLS, MINNESOTA MUNICIPAL AIRPORT ZONING MAP**  
(PART OF THE MUNICIPAL AIRPORT ZONING ORDINANCE.)

ADOPTED BY THE CITY OF RED LAKE FALLS - RED LAKE COUNTY AIRPORT ZONING BOARD  
 THIS \_\_\_\_\_ DAY OF \_\_\_\_\_, 1976. APPROVED \_\_\_\_\_ CHAIRMAN

Published in THE GAZETTE, RED LAKE FALLS, RED LAKE COUNTY this \_\_\_\_\_ day of \_\_\_\_\_, 1976

**PRELIMINARY PLANS**  
**NOT TO BE USED FOR CONSTRUCTION**



REVISIONS AND AMENDMENTS		
DATE	DESCRIPTION	BY

I HEREBY CERTIFY THAT THIS PLAN WAS PREPARED BY ME AND THAT I AM A DULY REGISTERED PROFESSIONAL ENGINEER UNDER THE LAWS OF THE STATE OF MINNESOTA.

DATE \_\_\_\_\_ REG. NO. \_\_\_\_\_  
 WIOSETH SMITH HOLDING & ASSOCIATES, INC.  
 CROOKSTON, MINNESOTA

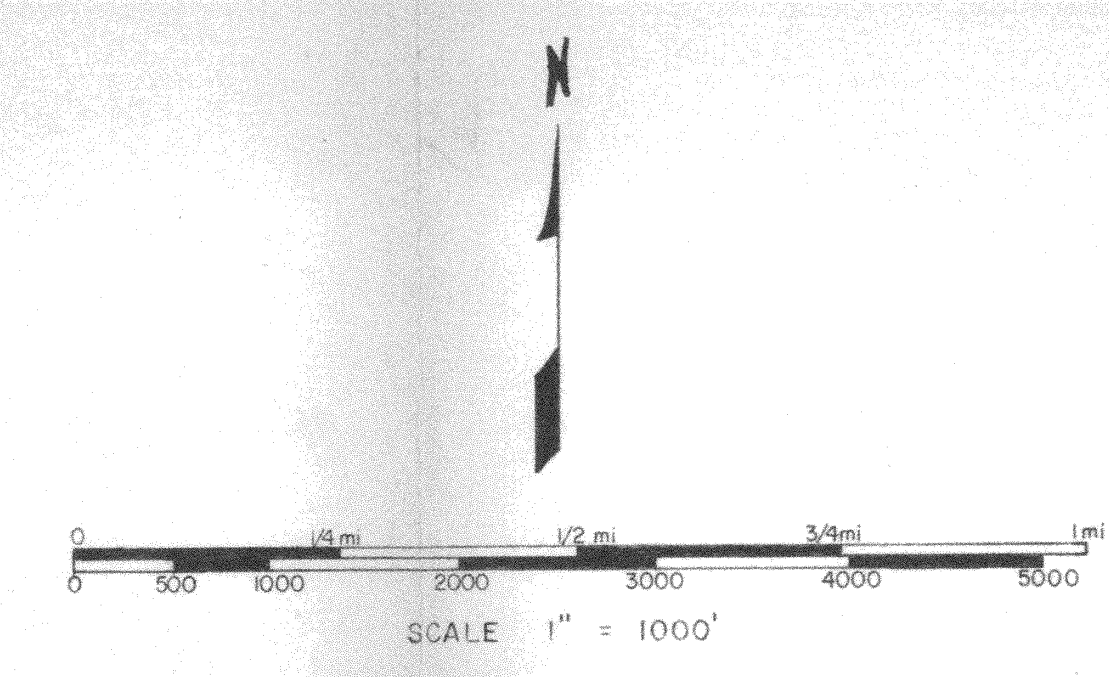
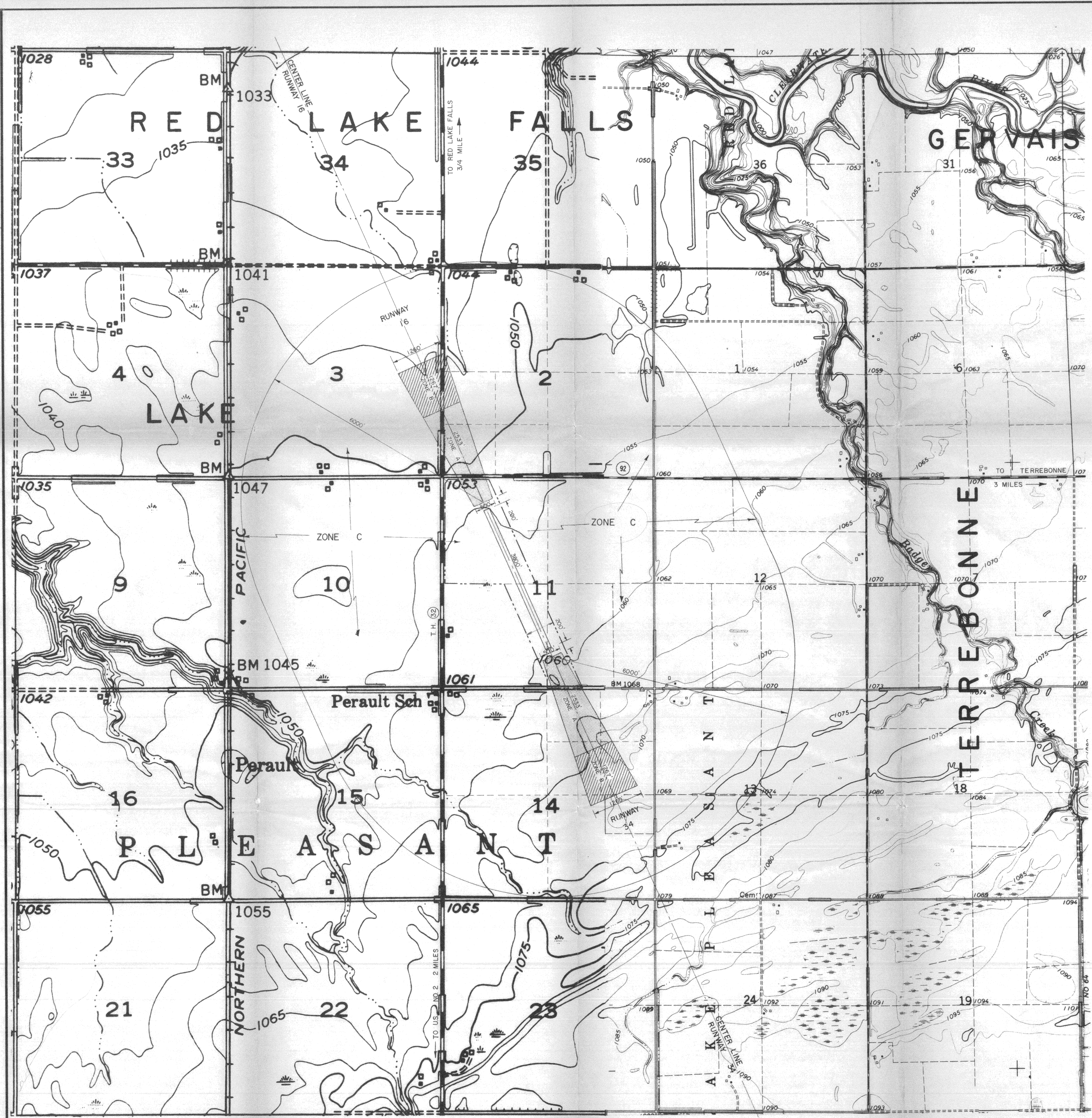

**NOTES**

- AIRPORT ELEVATION 1061 SEA LEVEL DATUM
- THE AERIAL CONTOURS ILLUSTRATE THE HEIGHT LIMITATIONS WITHIN EACH IMAGINARY SURFACE. THE CONTOURS ARE ON SEA LEVEL ELEVATION DATUM.
- A SLOPE, SUCH AS 40:1 EXPRESSES THE HORIZONTAL DISTANCE OF 40 FEET TO THE VERTICAL DISTANCE OF 1 FOOT.
- EXISTING TOPOGRAPHIC SYMBOLS ARE THOSE USED BY THE U.S. GEOLOGICAL SURVEY.
- THE BASE MAP IS A REPRODUCTION OF:  
 RED LAKE FALLS, MINNESOTA QUADRANGLE  
 1952 - 15 MINUTE SERIES  
 TERREBONNE, MINNESOTA QUADRANGLE  
 1964 - 7.5 MINUTE SERIES

**LEGEND**

- AIRPORT BOUNDARY - EXISTING
  - TOPOGRAPHIC CONTOURS \*
  - AERIAL CONTOURS
- \* FROM U.S. GEOLOGICAL SURVEY MAP  
 15 MINUTE SERIES & 7.5 MINUTE SERIES
- ESTABLISHED LAND USE ZONES (Referenced to Ordinance)**
- ZONE A
  - ZONE B
  - ZONE C

JANUARY 30, 1976  
**RED LAKE FALLS, MINNESOTA MUNICIPAL AIRPORT ZONING MAP**  
 (PART OF THE MUNICIPAL AIRPORT ZONING ORDINANCE)

ADOPTED BY THE CITY OF RED LAKE FALLS - RED LAKE COUNTY AIRPORT ZONING BOARD  
 THIS \_\_\_\_\_ DAY OF \_\_\_\_\_, 1976. APPROVED \_\_\_\_\_ CHAIRMAN

Published in THE GAZETTE, RED LAKE FALLS, RED LAKE COUNTY this \_\_\_\_\_ day of \_\_\_\_\_, 1976

**PRELIMINARY PLANS**  
**NOT TO BE USED FOR CONSTRUCTION**  
 DATE \_\_\_\_\_